

**RESOLUTION NO. 05-05-25**

**A RESOLUTION OF THE VILLAGE COUNCIL OF ISLAMORADA, VILLAGE OF ISLANDS, FLORIDA, ACCEPTING THE TRANSFER OF A PORTION OF OLD STATE ROAD 4-A AND STATE ROAD 905 FROM THE FLORIDA DEPARTMENT OF TRANSPORTATION (“FDOT”); DIRECTING THE VILLAGE MANAGER TO MAINTAIN THE ROADS; AUTHORIZING THE VILLAGE MANAGER TO EXPEND BUDGETED FUNDS; DIRECTING VILLAGE STAFF TO FORWARD THIS RESOLUTION TO FDOT; AND PROVIDING FOR AN EFFECTIVE DATE.**

**WHEREAS**, pursuant to Section 335.0145, Florida Statutes, jurisdiction and responsibility for public roads may be transferred by mutual agreement of the jurisdictions involved; and

**WHEREAS**, Section 337.29(3), Florida Statutes, provides that title to roads transferred pursuant to Section 335.0415, Florida Statutes, shall be in the government entity to which such roads have been transferred upon the recording of a right-of-way map in the public records; and

**WHEREAS**, on January 6, 2005, FDOT recorded a right-of-way map describing the transfer to Islamorada, Village of Islands (the “Village”) of a portion of old State Road 4-A and State Road 905 (the “Roads”), attached as Exhibit “A” (the “Map”) in Road Map Book 1, Page 145 of the Public Records of Monroe County; and

**WHEREAS**, on February 10, 2005, FDOT executed a quit claim deed, attached as Exhibit “B”, to transfer the ownership of the Roads to the Village; and

**WHEREAS**, by letter to the Village on February 10, 2005, FDOT’s Right-of-Way Administrator requested that the Village adopt a resolution acknowledging acceptance of the responsibility for the Roads in order to finalize the transfer; and

**WHEREAS**, the Village Council finds that it is in the best interests of the Village to adopt said resolution and finalize the transfer of the Roads.

NOW, THEREFORE, IT IS HEREBY RESOLVED BY THE VILLAGE COUNCIL OF ISLAMORADA, VILLAGE OF ISLANDS, FLORIDA, AS FOLLOWS:

**Section 1. Recitals.** The above recitals are true and correct and are incorporated herein by this reference.

**Section 2. Acceptance of Roads.** The Village accepts the quit claim deed, attached as Exhibit "B", and accepts responsibility for that portion of old State Road 4-A and State Road 905 as designated on the Map, as of the effective date of this resolution or the recordation of the quit claim deed, whichever is the latter.

**Section 3. Maintenance of Roadways.** The Village Manager is directed to take all steps necessary to provide for the maintenance of the Roads.

**Section 4. Authorization of Fund Expenditure.** The Village Manager is authorized to expend budgeted funds to maintain the Roads.

**Section 5. Transmittal of Resolution.** Village staff is directed to forward this resolution to the Florida Department of Transportation.

**Section 6. Effective Date.** This Resolution shall become effective immediately upon its adoption.

The foregoing Resolution was offered by Councilman Sante, who moved for its adoption. This motion was seconded by Vice Mayor Schmidt, and upon being put to a vote, the vote was as follows:

FINAL VOTE AT ADOPTION

VILLAGE COUNCIL OF ISLAMORADA, VILLAGE OF ISLANDS

Mayor Robert Johnson	YES
Vice Mayor Patricia Schmidt	YES
Councilman Mike Forster	YES

Councilman Michael Reckwerdt  
Councilman Chris Sante

YES  
YES

(THIS PORTION OF THE DOCUMENT HAS BEEN INTENTIONAL LEFT BLANK)

PASSED AND ADOPTED ON THIS 12<sup>th</sup> DAY OF MAY, 2005.

  
\_\_\_\_\_  
ROBERT JOHNSON, MAYOR

ATTEST:

  
\_\_\_\_\_  
VILLAGE CLERK

APPROVED AS TO FORM AND LEGALITY  
FOR THE USE AND BENEFIT OF ISLAMORADA,  
VILLAGE OF ISLANDS ONLY

  
\_\_\_\_\_  
VILLAGE ATTORNEY



STATE OF FLORIDA  
DEPARTMENT OF TRANSPORTATION

MAP OF THE  
STATE ROAD 5  
MONROE COUNTY, FLORIDA

TRANSFER MAP  
TO CONVEY PORTIONS OF  
OLD STATE ROAD 4-A & STATE ROAD 905  
TO THE VILLAGE OF ISLAMORADA  
SECTION 90060

LEGEND

- AC ACRE
- B BASELINE
- BL BUILDING
- C.M. CEMENT
- CONC. CONCRETE
- COR. CORNER
- D DEGREE
- DA DASHED ANGLE
- DE DENSE
- F.A.P. FEDERAL AID PROJECT
- F.D.O.T. FLORIDA DEPARTMENT OF TRANSPORTATION
- FO FOUND
- FOOT FEET
- RECT. RECTANGLE
- IR.I.R. IRON ROD AND CAP
- N.R. NORTHERN ROAD
- L LENGTH OF CURVE
- LB LICENSED BUSINESS
- LOC. LOCATION
- L.F. LEFT
- M METERS
- MM MILLIMETERS
- N/A NOT APPLICABLE
- NO. NUMBER
- COUNTY LINE
- TOWNSHIP LINE
- CITY LIGHT LINE
- FENCE LINE
- RIGHT OF WAY LINE
- BOUNDARY SURVEY
- LIMITED ACCESS LINE
- EXIST. LIMITED ACCESS
- LIMITS OF CONSTRUCTION
- PROPERTY LINE (E.I.S.T., R.W.)
- TEMP. BARRICADE AGREEMENT
- 1/4 SECTION LINE
- STATE LINE
- GRANT LINE
- CONVEYANCE
- NATIONAL STATE PARK
- OR FOREST

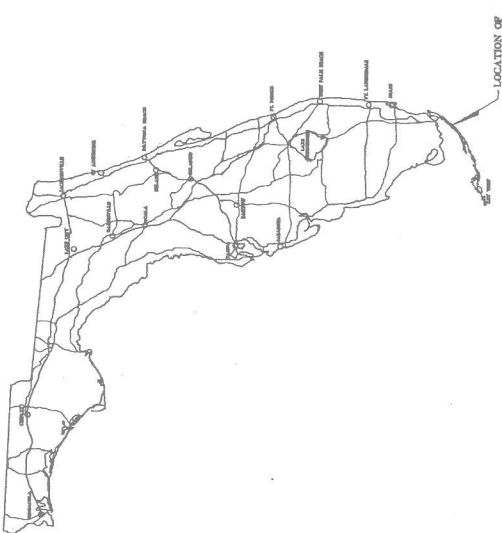
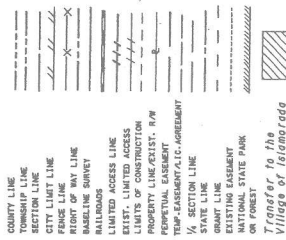

- SURVEY NOTES
1. RECOVERED BASELINE CONTROL POINTS AS PER F.D.O.T. RW MAP SECTION 50060, 8000-2814, AND FIELD NOTES.
  2. TRANSFERRED AND/OR R.P.S. ALL BASELINE CONTROL POINTS LISTED AND CLASSIFIED BY F.D.O.T. CONTROL POINTS.
  3. ESTABLISHED STATE PLUMB COORDINATES ON ALL BASELINE CONTROL POINTS USING F.D.O.T. CONTROL POINTS (AND IN DATUM/WD ADJUSTMENT).
  4. ALL EXISTING STRUCTURES WERE INTERSECTED WITH ESTABLISHED CONTROL BASELINE.
  5. DISCREPANCIES WERE ESTABLISHED USING POINTS ON STREETS OR SPLITTING OF PARALLEL WERE NO POINTS WERE FOUND.
  6. ALL FIELDWORK WAS PERFORMED IN COMPLIANCE WITH F.D.O.T. CONTROL POINTS.
  7. ALL FIELDWORK WAS PERFORMED IN COMPLIANCE WITH F.D.O.T. CONTROL POINTS.

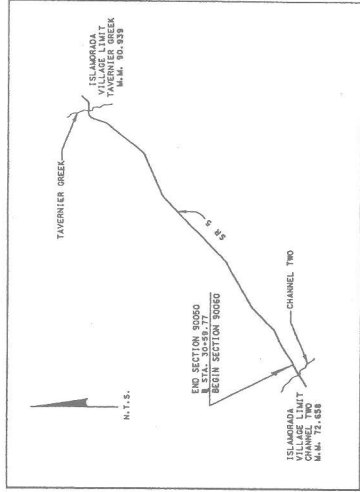

This right-of-way map when recorded is an instrument of title conveying, transferring, in accordance with Florida Statutes 337.25, all right, title and interest of the State of Florida Department of Transportation in the roads, streets, highways and alleys set forth on this map to the Village of Islamorada as shown on the legend.

Filed for record on this 6th day of SEPT, A.D. 2008 at 11:00 A.M. in Book No. 1111, Page 1111, of the Public Records of Monroe County, Florida.

By: Isidoro L. Kolchak  
 Clerk of Circuit Court  
 Monroe County, Florida

LIMITS OF TRANSFER MAP

APPROVED BY: <u>[Signature]</u>	DATE: <u>10/15/08</u>	SECTION 90060	STATE ROAD NO. 5	MONROE COUNTY	COVER SHEET
PROJECT NO. <u>1111</u>	DATE: <u>10/15/08</u>	SECTION 90060	STATE ROAD NO. 5	MONROE COUNTY	SHEET 1 OF 16

SCALE: 1"=200'  
TYP. 643 - REC. 382

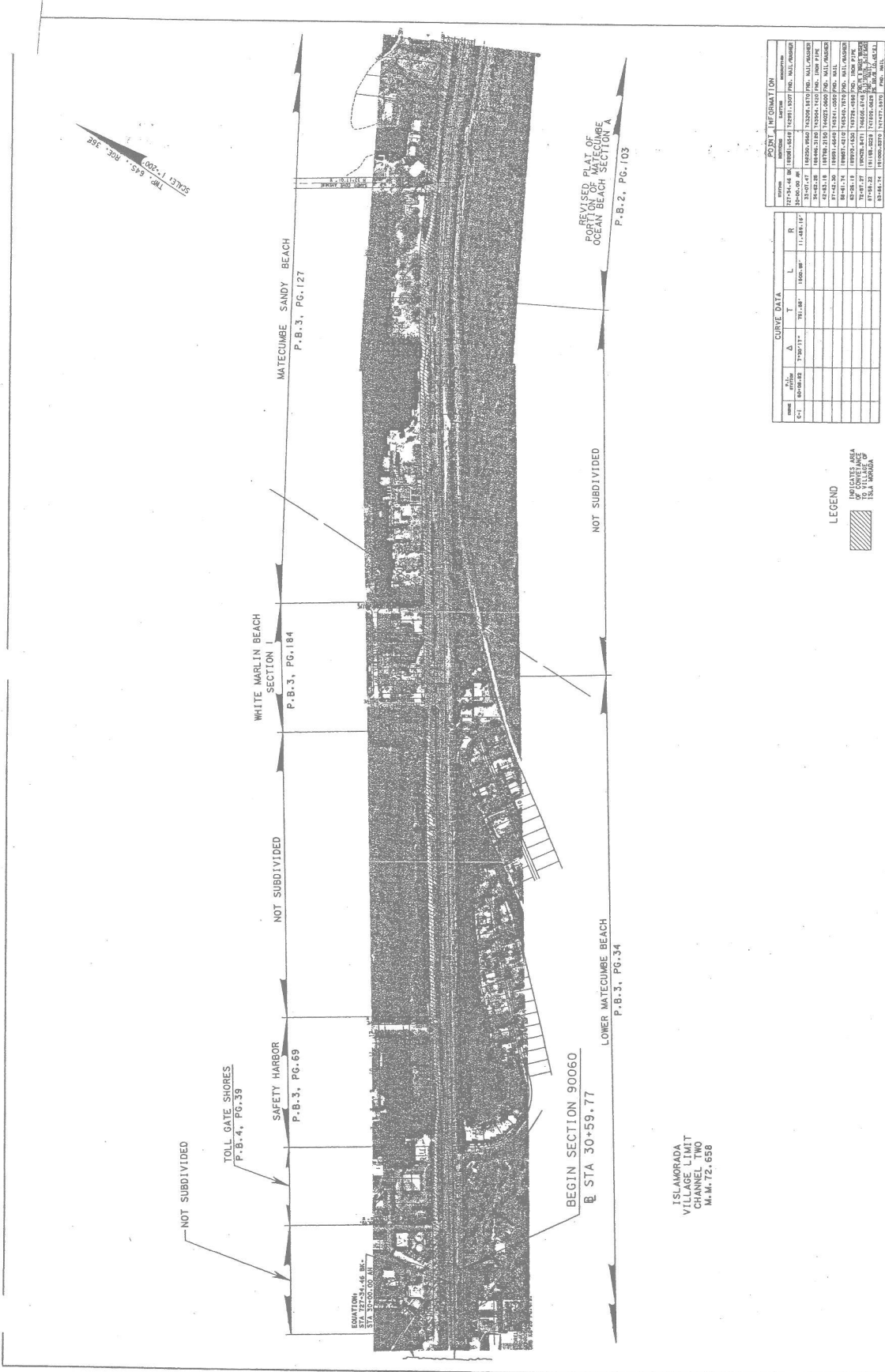

ISLANDORADA  
VILLAGE LIMIT  
CHANNEL TWO  
M. M. 72-658

Station	Curve Data	Point of Origin	Point of Tangency	Point of Intersection
0+00	Δ=115.00, R=1500.00, T=11.489, L=1600.00	127554.48	127554.48	127554.48
0+10		127554.48	127554.48	127554.48
0+20		127554.48	127554.48	127554.48
0+30		127554.48	127554.48	127554.48
0+40		127554.48	127554.48	127554.48
0+50		127554.48	127554.48	127554.48
0+60		127554.48	127554.48	127554.48
0+70		127554.48	127554.48	127554.48
0+80		127554.48	127554.48	127554.48
0+90		127554.48	127554.48	127554.48
1+00		127554.48	127554.48	127554.48
1+10		127554.48	127554.48	127554.48
1+20		127554.48	127554.48	127554.48
1+30		127554.48	127554.48	127554.48
1+40		127554.48	127554.48	127554.48
1+50		127554.48	127554.48	127554.48
1+60		127554.48	127554.48	127554.48
1+70		127554.48	127554.48	127554.48
1+80		127554.48	127554.48	127554.48
1+90		127554.48	127554.48	127554.48
2+00		127554.48	127554.48	127554.48
2+10		127554.48	127554.48	127554.48
2+20		127554.48	127554.48	127554.48
2+30		127554.48	127554.48	127554.48
2+40		127554.48	127554.48	127554.48
2+50		127554.48	127554.48	127554.48
2+60		127554.48	127554.48	127554.48
2+70		127554.48	127554.48	127554.48
2+80		127554.48	127554.48	127554.48
2+90		127554.48	127554.48	127554.48
3+00		127554.48	127554.48	127554.48
3+10		127554.48	127554.48	127554.48
3+20		127554.48	127554.48	127554.48
3+30		127554.48	127554.48	127554.48
3+40		127554.48	127554.48	127554.48
3+50		127554.48	127554.48	127554.48
3+60		127554.48	127554.48	127554.48
3+70		127554.48	127554.48	127554.48
3+80		127554.48	127554.48	127554.48
3+90		127554.48	127554.48	127554.48
4+00		127554.48	127554.48	127554.48
4+10		127554.48	127554.48	127554.48
4+20		127554.48	127554.48	127554.48
4+30		127554.48	127554.48	127554.48
4+40		127554.48	127554.48	127554.48
4+50		127554.48	127554.48	127554.48
4+60		127554.48	127554.48	127554.48
4+70		127554.48	127554.48	127554.48
4+80		127554.48	127554.48	127554.48
4+90		127554.48	127554.48	127554.48
5+00		127554.48	127554.48	127554.48
5+10		127554.48	127554.48	127554.48
5+20		127554.48	127554.48	127554.48
5+30		127554.48	127554.48	127554.48
5+40		127554.48	127554.48	127554.48
5+50		127554.48	127554.48	127554.48
5+60		127554.48	127554.48	127554.48
5+70		127554.48	127554.48	127554.48
5+80		127554.48	127554.48	127554.48
5+90		127554.48	127554.48	127554.48
6+00		127554.48	127554.48	127554.48
6+10		127554.48	127554.48	127554.48
6+20		127554.48	127554.48	127554.48
6+30		127554.48	127554.48	127554.48
6+40		127554.48	127554.48	127554.48
6+50		127554.48	127554.48	127554.48
6+60		127554.48	127554.48	127554.48
6+70		127554.48	127554.48	127554.48
6+80		127554.48	127554.48	127554.48
6+90		127554.48	127554.48	127554.48
7+00		127554.48	127554.48	127554.48
7+10		127554.48	127554.48	127554.48
7+20		127554.48	127554.48	127554.48
7+30		127554.48	127554.48	127554.48
7+40		127554.48	127554.48	127554.48
7+50		127554.48	127554.48	127554.48
7+60		127554.48	127554.48	127554.48
7+70		127554.48	127554.48	127554.48
7+80		127554.48	127554.48	127554.48
7+90		127554.48	127554.48	127554.48
8+00		127554.48	127554.48	127554.48
8+10		127554.48	127554.48	127554.48
8+20		127554.48	127554.48	127554.48
8+30		127554.48	127554.48	127554.48
8+40		127554.48	127554.48	127554.48
8+50		127554.48	127554.48	127554.48
8+60		127554.48	127554.48	127554.48
8+70		127554.48	127554.48	127554.48
8+80		127554.48	127554.48	127554.48
8+90		127554.48	127554.48	127554.48
9+00		127554.48	127554.48	127554.48
9+10		127554.48	127554.48	127554.48
9+20		127554.48	127554.48	127554.48
9+30		127554.48	127554.48	127554.48
9+40		127554.48	127554.48	127554.48
9+50		127554.48	127554.48	127554.48
9+60		127554.48	127554.48	127554.48
9+70		127554.48	127554.48	127554.48
9+80		127554.48	127554.48	127554.48
9+90		127554.48	127554.48	127554.48
10+00		127554.48	127554.48	127554.48

LEGEND  
 [Hatched Box] INDICATES AREA TO BE CONVEYED TO ISLA MONROE

APPROVED BY	DATE	SECTION	STATE ROAD NO.	COUNTY
[Signature]	11/18/2021	SECTION 90060	5	MONROE COUNTY
FLORIDA DEPARTMENT OF TRANSPORTATION SR-4A TRANSFER MAP				
PREPARED BY	DATE	SCALE	SHEET 2 OF 16	
JURA, INC.	11/18/2021	AS SHOWN		

SCALE: 1"=200'  
 MAP 645, P.C.C. 386

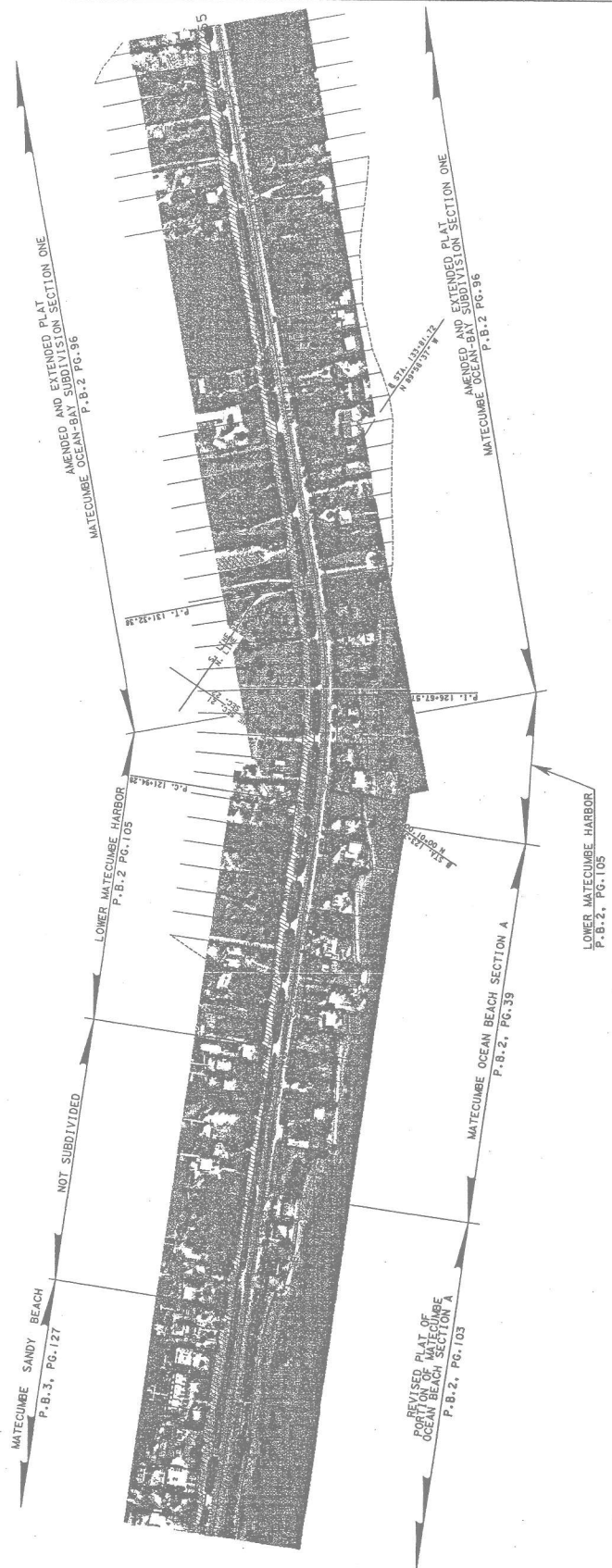

CURVE DATA		POINT INFORMATION	
Station	Station	Station	Station
0+00	100+00	100+00	100+00
0+10	100+10	100+10	100+10
0+20	100+20	100+20	100+20
0+30	100+30	100+30	100+30
0+40	100+40	100+40	100+40
0+50	100+50	100+50	100+50
0+60	100+60	100+60	100+60
0+70	100+70	100+70	100+70
0+80	100+80	100+80	100+80
0+90	100+90	100+90	100+90
1+00	100+00	100+00	100+00
1+10	100+10	100+10	100+10
1+20	100+20	100+20	100+20
1+30	100+30	100+30	100+30
1+40	100+40	100+40	100+40
1+50	100+50	100+50	100+50
1+60	100+60	100+60	100+60
1+70	100+70	100+70	100+70
1+80	100+80	100+80	100+80
1+90	100+90	100+90	100+90
2+00	100+00	100+00	100+00
2+10	100+10	100+10	100+10
2+20	100+20	100+20	100+20
2+30	100+30	100+30	100+30
2+40	100+40	100+40	100+40
2+50	100+50	100+50	100+50
2+60	100+60	100+60	100+60
2+70	100+70	100+70	100+70
2+80	100+80	100+80	100+80
2+90	100+90	100+90	100+90
3+00	100+00	100+00	100+00
3+10	100+10	100+10	100+10
3+20	100+20	100+20	100+20
3+30	100+30	100+30	100+30
3+40	100+40	100+40	100+40
3+50	100+50	100+50	100+50
3+60	100+60	100+60	100+60
3+70	100+70	100+70	100+70
3+80	100+80	100+80	100+80
3+90	100+90	100+90	100+90
4+00	100+00	100+00	100+00
4+10	100+10	100+10	100+10
4+20	100+20	100+20	100+20
4+30	100+30	100+30	100+30
4+40	100+40	100+40	100+40
4+50	100+50	100+50	100+50
4+60	100+60	100+60	100+60
4+70	100+70	100+70	100+70
4+80	100+80	100+80	100+80
4+90	100+90	100+90	100+90
5+00	100+00	100+00	100+00

LEGEND  
 INDICATES AREA OF CONVEYANCE TO TILA WINDS

SR-5 SECTION 90060

FLORIDA DEPARTMENT OF TRANSPORTATION  
 SR-4A TRANSFER MAP

APPROVED BY: [Signature]  
 DATE: 11/14/14

SECTION 90060  
 STATE ROAD NO. 5 MONROE COUNTY

MAP PREPARED BY: INC.  
 P.O. BOX 100, MONROE, LA 70646

FILED MAP NO. 7  
 SCALE: 1"=200'

SHEET 3 OF 16

SCALE 1"=200'  
 TYP. CAS. REF. BE

MATECUMBE OCEAN-BAY SUBDIVISION SECTION TWO  
 P.B.2 PG.98

AMENDED AND EXTENDED PLAT MATECUMBE  
 OCEAN-BAY SUBDIVISION SECTION ONE  
 P.B.2 PG.96

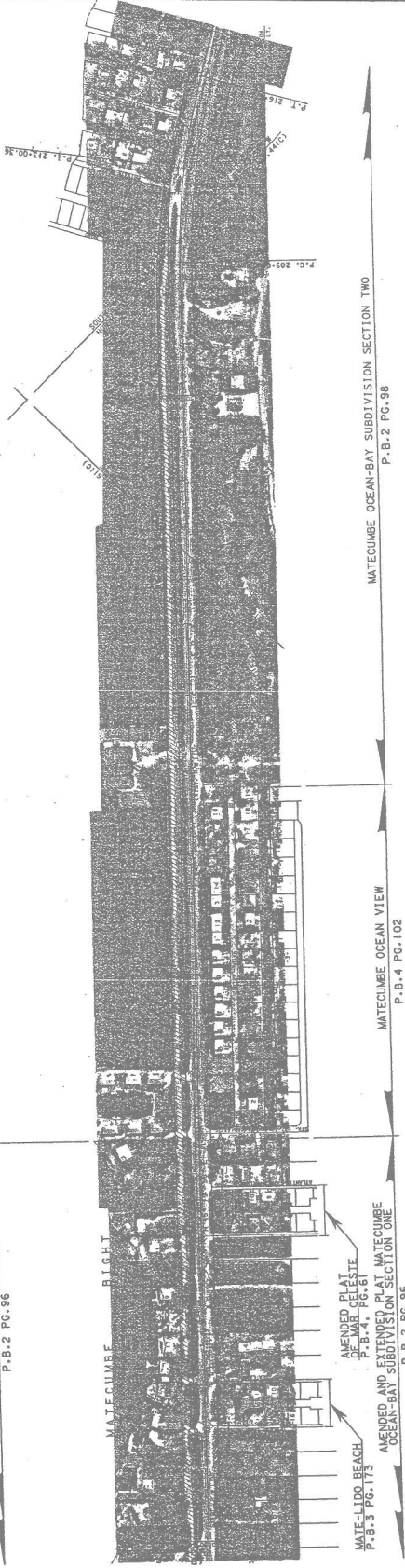

CURVE DATA		POINT INFORMATION	
STATION	CHORD	STATION	COORDINATES
0+00	135.0000	1+00.00	131742.6445
0+25	33.5000	1+00.00	131742.6445
0+50	67.0000	1+00.00	131742.6445
0+75	100.5000	1+00.00	131742.6445
1+00.00	135.0000	1+00.00	131742.6445
1+25	100.5000	1+00.00	131742.6445
1+50	67.0000	1+00.00	131742.6445
1+75	33.5000	1+00.00	131742.6445
2+00.00	0.0000	1+00.00	131742.6445

LEGEND  
 INDICATES AREA  
 TO BE LIFTED  
 15' IN HEIGHT

SECTION 90060	SECTION 90060	FILE NO. 73
STATE ROAD NO. 5	MONROE COUNTY	SCALE: 1"=200'
DATE: _____	DATE: _____	DATE: _____
BY: _____	BY: _____	BY: _____
CHECKED: _____	CHECKED: _____	CHECKED: _____
DATE: _____	DATE: _____	DATE: _____
BY: _____	BY: _____	BY: _____
CHECKED: _____	CHECKED: _____	CHECKED: _____
DATE: _____	DATE: _____	DATE: _____
BY: _____	BY: _____	BY: _____
CHECKED: _____	CHECKED: _____	CHECKED: _____

APPROVED BY: *[Signature]* DATE: \_\_\_\_\_

FLORIDA DEPARTMENT OF TRANSPORTATION  
 SR-4A TRANSFER MAP

SR-5 SECTION 90060

SCALE 1"=200'  
 T.M.C. 645, 602, 392

MATECUMBE OCEAN-BAY  
 SUBDIVISION SECTION TWO  
 P.B.2 PG.38

MATECUMBE OCEAN-BAY  
 SUBDIVISION SECTION TWO  
 P.B.2 PG.38

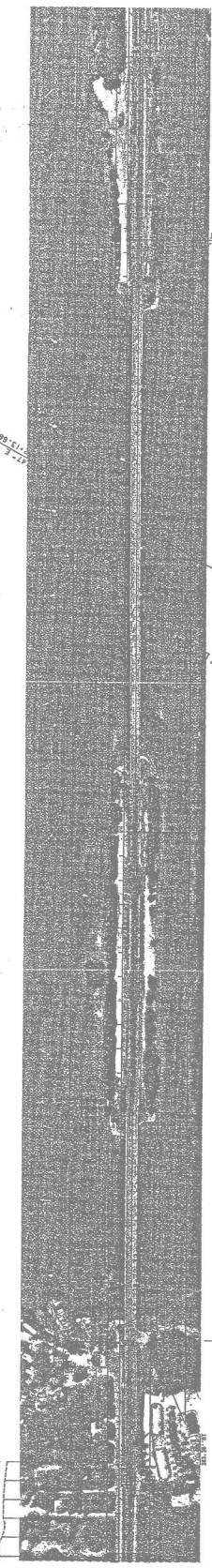

OCEAN

P.L. 212-92  
 4-20-01

IN

WEST LINE SEC. 11  
 EAST LINE SEC. 11

STATION	ELEV.	CURVE DATA			POINT INFORMATION		
		A	T	R	PC	PT	PI

SR-5 SECTION 90060  
 FLORIDA DEPARTMENT OF TRANSPORTATION  
 SR-4A TRANSFER MAP  
 PREPARED BY  
 DATE  
 SECTION NO. 5  
 STATE ROAD NO. 5  
 MONROE COUNTY  
 FILED BOOK NO. 75  
 SHEET 5 OF 16

MAP SCALE 1"=200'  
 TWP. 45S. R06E. S36E. & R05E. S7E.

NOT SUBDIVIDED  
 SURVEY LINE AS SHOWN ON  
 EXCEPTION SEC. 90060-2018  
 COUNTY OF  
 TEATABLE PARK  
 PLAT BOOK 2, PAGE 44  
 P.L. 337-11-11  
 6-02-19-11

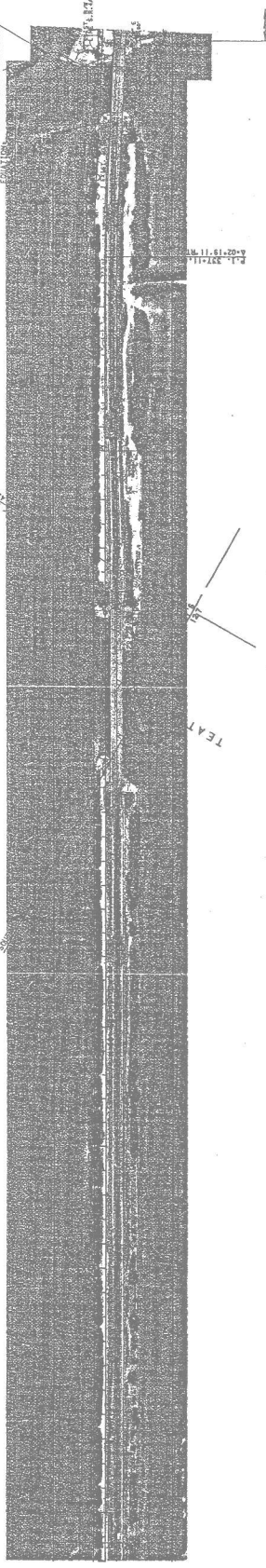

CURVE DATA		POINT INFORMATION	
STATION	ANGLE	STATION	DESCRIPTION
0+00.00	90.00	0+00.00	START OF CURVE
0+10.00		0+10.00	
0+20.00		0+20.00	
0+30.00		0+30.00	
0+40.00		0+40.00	
0+50.00		0+50.00	
0+60.00		0+60.00	
0+70.00		0+70.00	
0+80.00		0+80.00	
0+90.00		0+90.00	
1+00.00		1+00.00	END OF CURVE

APPROVED BY: *[Signature]* DATE: *[Date]*  
 FLORIDA DEPARTMENT OF TRANSPORTATION  
 SR-4A TRANSFER MAP  
 SECTION 90060  
 STATE ROAD NO. 5 MONROE COUNTY  
 MAPS PROVIDED BY: JRE & ASSOCIATES, INC.  
 11111 N. ...  
 ...  
 SHEET 6 OF 16

THE GCS & IMP. 66C-1, 66C-2, 66C-3, 66C-4, 66C-5, 66C-6, 66C-7, 66C-8, 66C-9, 66C-10, 66C-11, 66C-12, 66C-13, 66C-14, 66C-15, 66C-16, 66C-17, 66C-18, 66C-19, 66C-20, 66C-21, 66C-22, 66C-23, 66C-24, 66C-25, 66C-26, 66C-27, 66C-28, 66C-29, 66C-30, 66C-31, 66C-32, 66C-33, 66C-34, 66C-35, 66C-36, 66C-37, 66C-38, 66C-39, 66C-40, 66C-41, 66C-42, 66C-43, 66C-44, 66C-45, 66C-46, 66C-47, 66C-48, 66C-49, 66C-50, 66C-51, 66C-52, 66C-53, 66C-54, 66C-55, 66C-56, 66C-57, 66C-58, 66C-59, 66C-60, 66C-61, 66C-62, 66C-63, 66C-64, 66C-65, 66C-66, 66C-67, 66C-68, 66C-69, 66C-70, 66C-71, 66C-72, 66C-73, 66C-74, 66C-75, 66C-76, 66C-77, 66C-78, 66C-79, 66C-80, 66C-81, 66C-82, 66C-83, 66C-84, 66C-85, 66C-86, 66C-87, 66C-88, 66C-89, 66C-90, 66C-91, 66C-92, 66C-93, 66C-94, 66C-95, 66C-96, 66C-97, 66C-98, 66C-99, 66C-100

PALM HARBOR  
P-B-2, PG-1111

NOT SUBDIVIDED

UPPER MATECUMBE KEY

TEATABLE PARK  
PLAY BOOK 2, PAGE 44

NOT SUBDIVIDED

CARIBBE BEACH  
P-B-2, PG-62

NOT SUBDIVIDED

THE KEY  
P-B-2, PG-64

SUBDIVISION OF LOT 7 OF THE KEY  
P-B-2, PG-129

NOT SUBDIVIDED

COURT'S  
SUBDIVISION  
S/7116

NOT SUBDIVIDED

RICHARD J. WILLIAMS  
UNRECORDED PLAN

PALM HARBOR  
P-B-2, PG-1111

WESTINGER  
ART COLONY  
P-B-2, PG-84

CURVE DATA		POINT INFORMATION			
NAME	DATE	STATION	CHORD	CHORD BEARING	REMARKS
C-1	11-11-68	1+17.69	200.00	S 89° 45' 00" W	POINT OF BEGINNING
C-2	11-11-68	1+17.69	200.00	S 89° 45' 00" W	POINT OF BEGINNING
C-3	11-11-68	1+17.69	200.00	S 89° 45' 00" W	POINT OF BEGINNING

LEGEND  
INDICATES AREA  
AVAILABLE FOR  
CONSTRUCTION

SECTION 90060	STATE ROAD NO. 5	MONROE COUNTY
SECTION 90060	STATE ROAD NO. 5	MONROE COUNTY
SECTION 90060	STATE ROAD NO. 5	MONROE COUNTY



SHEET 1 OF 16  
 TRM 635 REG 316

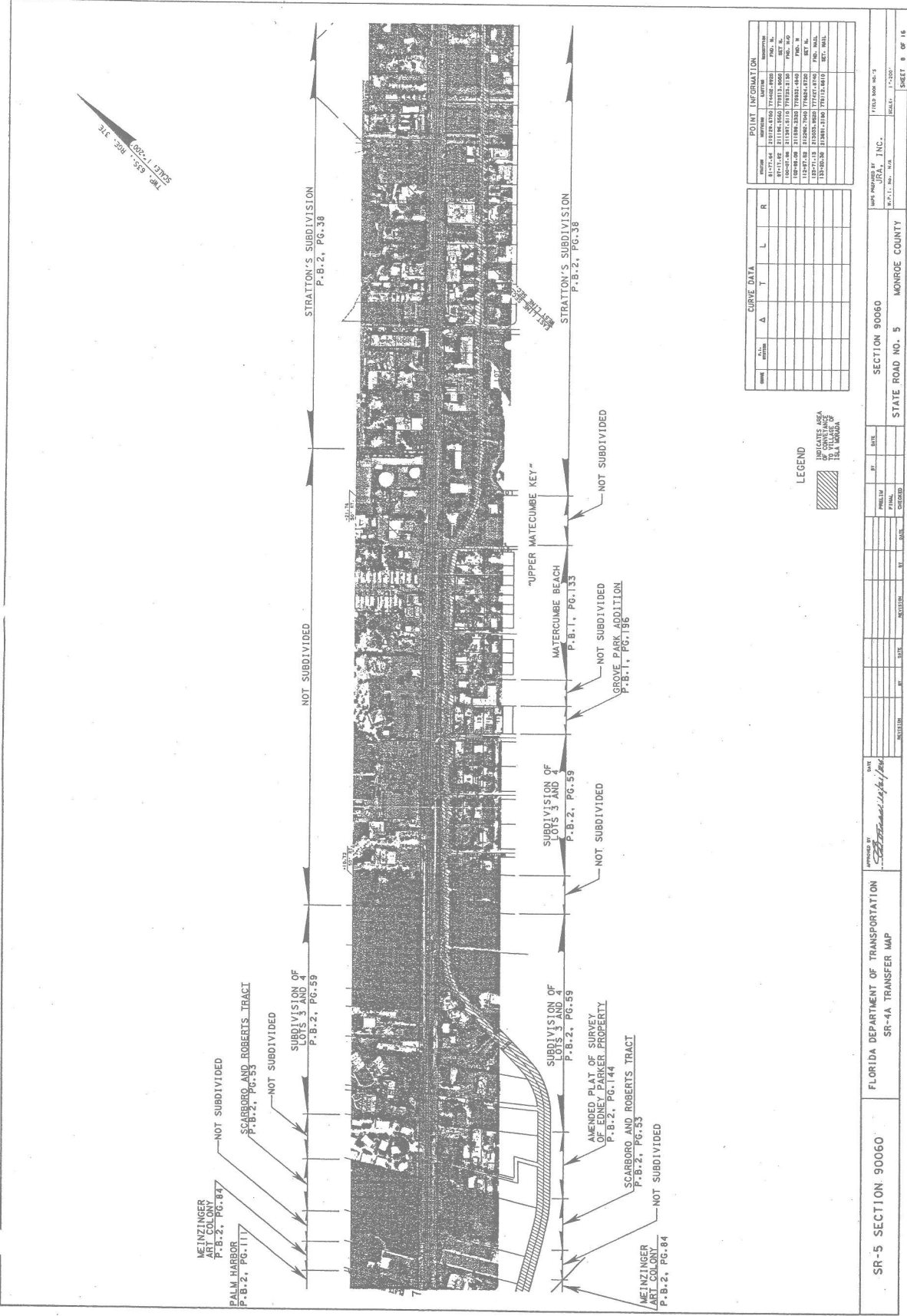

CURVE DATA			
STATION	CHORD	ANGLE	RADIUS

POINT INFORMATION			
NO.	EASTING	NORTHING	COORD. SYSTEM
1	8177.04	12578.420	TRANSVERSE
2	8177.04	12578.420	TRANSVERSE
3	8177.04	12578.420	TRANSVERSE
4	8177.04	12578.420	TRANSVERSE
5	8177.04	12578.420	TRANSVERSE
6	8177.04	12578.420	TRANSVERSE

**LEGEND**  
 UNDEVELOPED AREA TO BE VILLAGED AT LATER DATE

APPROVED BY: [Signature] DATE: 11/20/07				SECTION	DATE	BY	SECTION 9060 STATE ROAD NO. 5 MONROE COUNTY	FILED 9060 No. 5 REG. 11-20-07 11-20-07
				REVISION	DATE	BY		
FLORIDA DEPARTMENT OF TRANSPORTATION SR-4A TRANSFER MAP				SECTION	DATE	BY	9060 STATE ROAD NO. 5 MONROE COUNTY	FILED 9060 No. 5 REG. 11-20-07 11-20-07



SCALE 1"=200'  
 NAD 83  
 6551 - 1002 - 31E

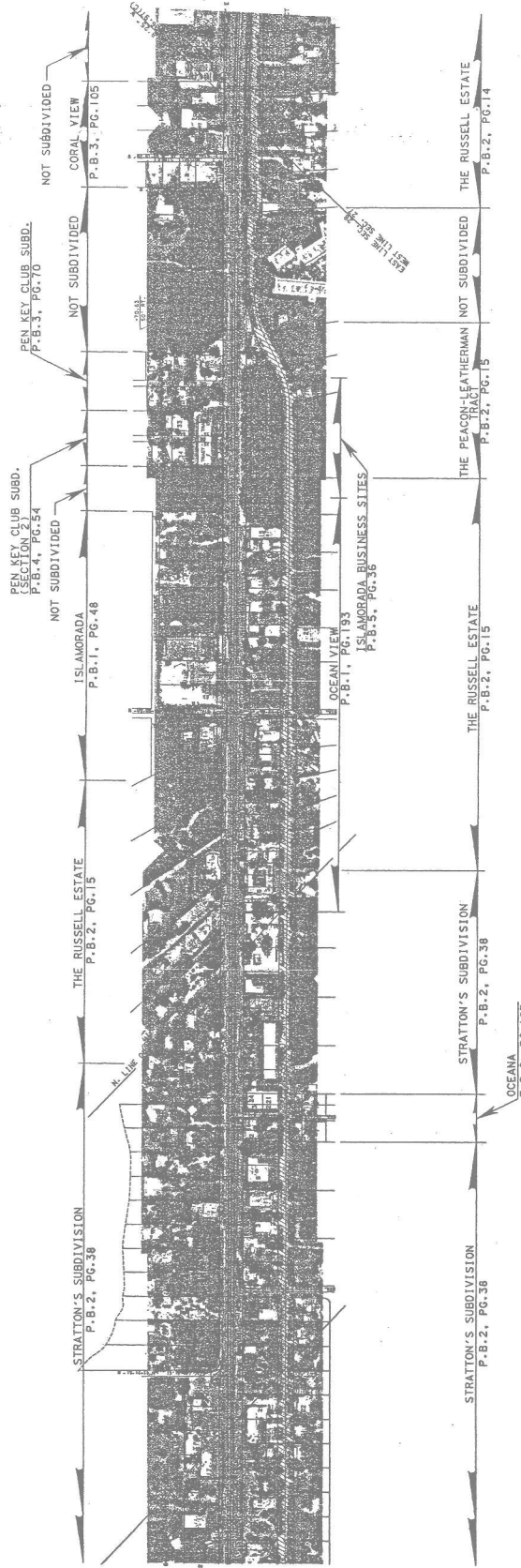

CURVE DATA		POINT INFORMATION	
STATION	ANGLE	STATION	ANGLE
100+00.00	117.047°	100+00.00	117.047°
100+20.00	117.047°	100+20.00	117.047°
100+40.00	117.047°	100+40.00	117.047°
100+60.00	117.047°	100+60.00	117.047°
100+80.00	117.047°	100+80.00	117.047°
101+00.00	117.047°	101+00.00	117.047°

LEGEND  
 Hatched area indicates area to be developed by the applicant in accordance with the approved plat.

APPROVED BY: *[Signature]* DATE: *[Date]*

FLORIDA DEPARTMENT OF TRANSPORTATION  
 SR-4A TRANSFER MAP

SECTION 90060  
 STATE ROAD NO. 5 MONROE COUNTY

PREPARED BY: JRA, INC.  
 8271 NW 8th Ave. MIAMI, FL 33150  
 PHONE: 772-200-1100

SCALE: 1"=200'

SHEET 9 OF 16

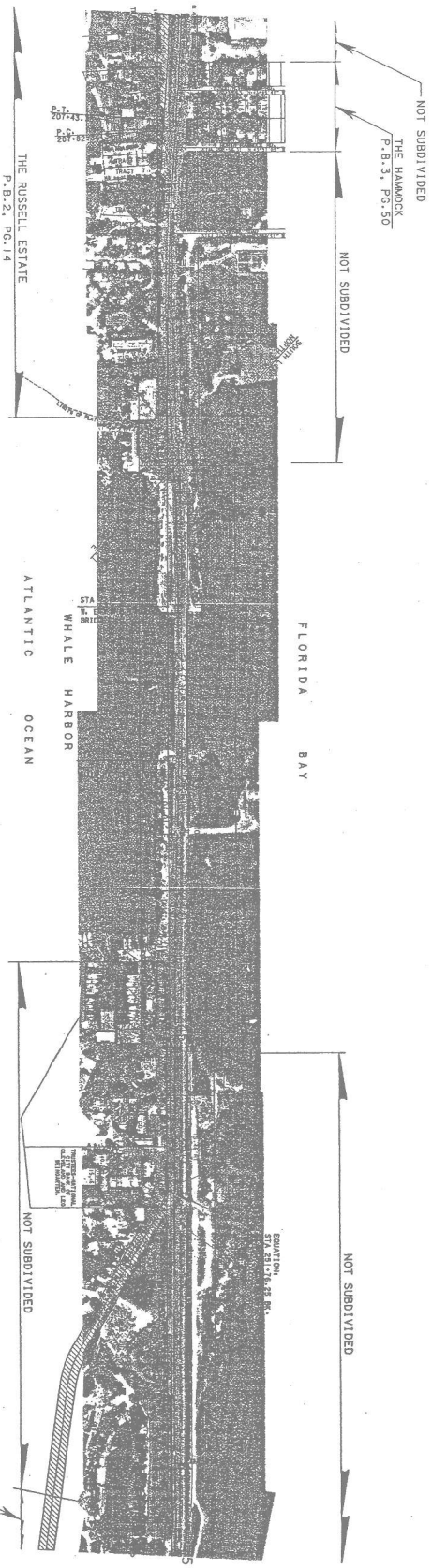

TRIP 635, REC. 37E  
SCALE 1"=200'

PLAT AND SURVEY OF SECTION 23-83-27  
BY GEORGE L. WOODWARD  
P.B. 1 PG. 50

LEGEND  
INDICATES AREA OF DISTANCE FROM BAY FRONTAGE

CORNERS	CURVE DATA			POINT INFORMATION
	CHORD	ANGLE	LENGTH	
C-4	217°17'50"	21.374+00'	1.178+00'	171.86+23'
C-3	154°17'14"	15.374+00'	1.018+00'	168.86+28'
C-2	134°17'14"	13.374+00'	0.818+00'	165.86+33'
C-1	114°17'14"	11.374+00'	0.618+00'	162.86+38'
B-1	94°17'14"	9.374+00'	0.418+00'	159.86+43'
A	74°17'14"	7.374+00'	0.218+00'	156.86+48'
1	54°17'14"	5.374+00'	0.018+00'	153.86+53'

SCALE 1"=200'  
7/25/95, REC. 375 B REC. 398

AMENDED AND EXTENDED PLAT OF  
VENETTIAN SHORES PLAT NO. 1  
P.B. 3, PG. 157

NOT SUBDIVIDED

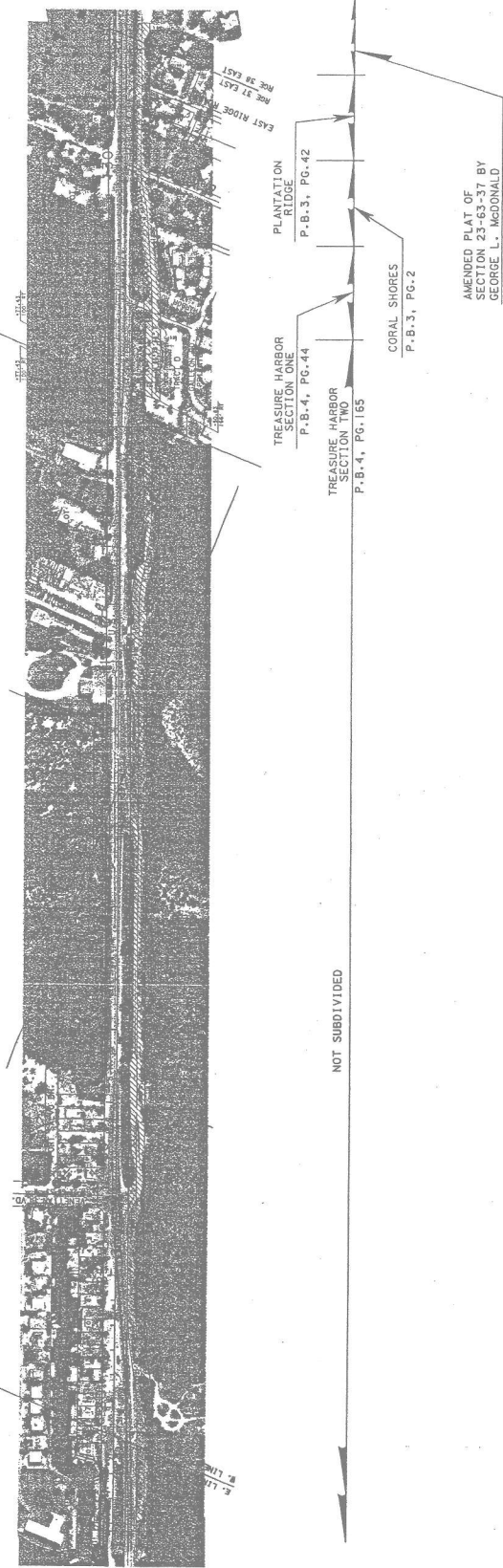

NOT SUBDIVIDED

LEGEND			
INDICATES AREA TO BE WIDENED TO ISLAND ROAD			
LEGEND			
DATE	TIME	BY	REVISION

INDICATES AREA TO BE WIDENED TO ISLAND ROAD

LEGEND

DATE	TIME	BY	REVISION	DATE	TIME	BY	REVISION	DATE	TIME	BY	REVISION

APPROVED BY:

DATE: 7/25/95

SECTION 90060

STATE ROAD NO. 5

MONROE COUNTY

FLORIDA DEPARTMENT OF TRANSPORTATION

SR-4A TRANSFER MAP

SR-5 SECTION 90060

DATE: 7/25/95

SCALE: 1"=200'

SCALE 1"=200'  
 IMP. G.S. ROE, 37E

AMENDED AND EXTENDED PLAT OF  
 VENETIAN SHORES PLAT NO. 11  
 P.B. 3, PG. 157

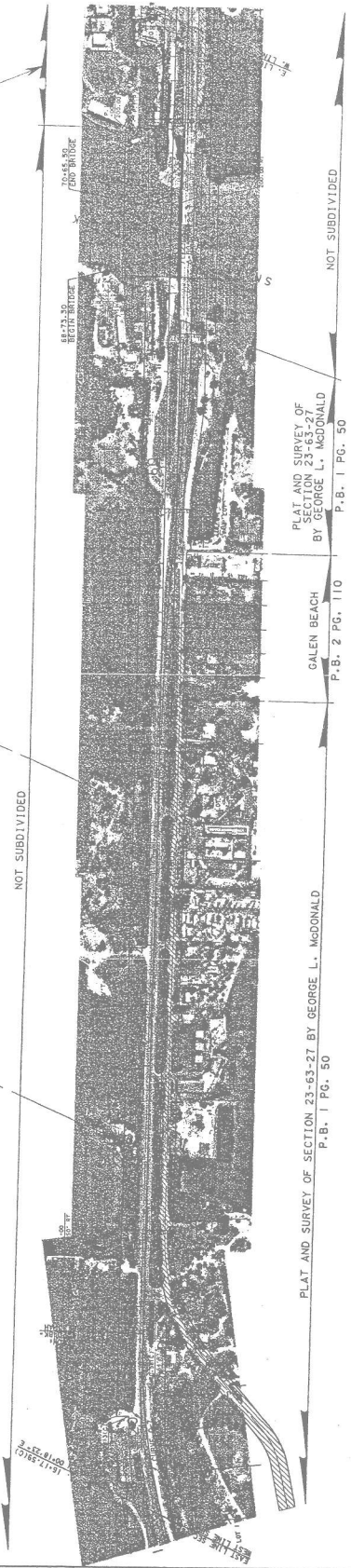

PLAT AND SURVEY OF SECTION 23-63-27 BY GEORGE L. McDONALD  
 P.B. 1 PG. 50

GALEN BEACH  
 P.B. 2 PG. 110

PLAT AND SURVEY OF SECTION 23-63-27  
 BY GEORGE L. McDONALD  
 P.B. 1 PG. 50

NOT SUBDIVIDED

CURVE DATA		POINT INFORMATION	
STATION	CHORD BEARING	POINT NO.	POINT DESCRIPTION
1+00.00	S 89° 15' 00" W 100.00	1	START OF CURVE
1+00.00	S 89° 15' 00" W 100.00	2	END OF CURVE
1+00.00	S 89° 15' 00" W 100.00	3	END OF CURVE

CURVE DATA		POINT INFORMATION	
STATION	CHORD BEARING	POINT NO.	POINT DESCRIPTION
1+00.00	S 89° 15' 00" W 100.00	1	START OF CURVE
1+00.00	S 89° 15' 00" W 100.00	2	END OF CURVE
1+00.00	S 89° 15' 00" W 100.00	3	END OF CURVE

LEGEND  
 Hatched area  
 indicates area  
 to be filled  
 with gravel

SR-5 SECTION 90060

FLORIDA DEPARTMENT OF TRANSPORTATION  
 SR-4A TRANSFER MAP

APPROVED BY: *George L. McDonald*

SECTION 90060  
 STATE ROAD NO. 5  
 MONROE COUNTY

FILED BOOK NO. 1  
 SHEET 11 OF 18



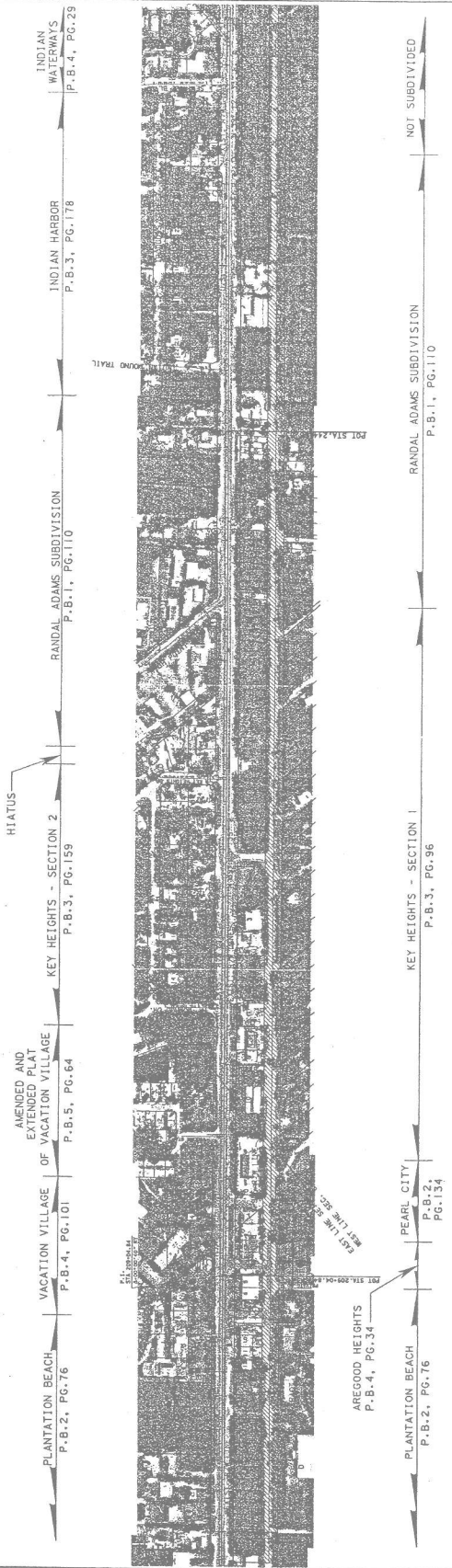

NO.	DATE	DESCRIPTION
1	11/15/00	PLAT
2	11/15/00	PLAT
3	11/15/00	PLAT
4	11/15/00	PLAT
5	11/15/00	PLAT
6	11/15/00	PLAT
7	11/15/00	PLAT
8	11/15/00	PLAT
9	11/15/00	PLAT
10	11/15/00	PLAT
11	11/15/00	PLAT
12	11/15/00	PLAT
13	11/15/00	PLAT
14	11/15/00	PLAT
15	11/15/00	PLAT
16	11/15/00	PLAT
17	11/15/00	PLAT
18	11/15/00	PLAT
19	11/15/00	PLAT
20	11/15/00	PLAT
21	11/15/00	PLAT
22	11/15/00	PLAT
23	11/15/00	PLAT
24	11/15/00	PLAT
25	11/15/00	PLAT
26	11/15/00	PLAT
27	11/15/00	PLAT
28	11/15/00	PLAT
29	11/15/00	PLAT
30	11/15/00	PLAT
31	11/15/00	PLAT
32	11/15/00	PLAT
33	11/15/00	PLAT
34	11/15/00	PLAT
35	11/15/00	PLAT
36	11/15/00	PLAT
37	11/15/00	PLAT
38	11/15/00	PLAT
39	11/15/00	PLAT
40	11/15/00	PLAT
41	11/15/00	PLAT
42	11/15/00	PLAT
43	11/15/00	PLAT
44	11/15/00	PLAT
45	11/15/00	PLAT
46	11/15/00	PLAT
47	11/15/00	PLAT
48	11/15/00	PLAT
49	11/15/00	PLAT
50	11/15/00	PLAT
51	11/15/00	PLAT
52	11/15/00	PLAT
53	11/15/00	PLAT
54	11/15/00	PLAT
55	11/15/00	PLAT
56	11/15/00	PLAT
57	11/15/00	PLAT
58	11/15/00	PLAT
59	11/15/00	PLAT
60	11/15/00	PLAT
61	11/15/00	PLAT
62	11/15/00	PLAT
63	11/15/00	PLAT
64	11/15/00	PLAT
65	11/15/00	PLAT
66	11/15/00	PLAT
67	11/15/00	PLAT
68	11/15/00	PLAT
69	11/15/00	PLAT
70	11/15/00	PLAT
71	11/15/00	PLAT
72	11/15/00	PLAT
73	11/15/00	PLAT
74	11/15/00	PLAT
75	11/15/00	PLAT
76	11/15/00	PLAT
77	11/15/00	PLAT
78	11/15/00	PLAT
79	11/15/00	PLAT
80	11/15/00	PLAT
81	11/15/00	PLAT
82	11/15/00	PLAT
83	11/15/00	PLAT
84	11/15/00	PLAT
85	11/15/00	PLAT
86	11/15/00	PLAT
87	11/15/00	PLAT
88	11/15/00	PLAT
89	11/15/00	PLAT
90	11/15/00	PLAT
91	11/15/00	PLAT
92	11/15/00	PLAT
93	11/15/00	PLAT
94	11/15/00	PLAT
95	11/15/00	PLAT
96	11/15/00	PLAT
97	11/15/00	PLAT
98	11/15/00	PLAT
99	11/15/00	PLAT
100	11/15/00	PLAT

SR-5 SECTION 90060

FLORIDA DEPARTMENT OF TRANSPORTATION  
SR-4A TRANSFER MAP

DESIGNED BY: *[Signature]*

SECTION 90060  
STATE ROAD NO. 5 MONROE COUNTY

SCALE: 1"=200'

SHEET 14 OF 16



SECTION 90060		STATE ROAD NO. 5		MONROE COUNTY	
<p>APPROVED BY: <i>[Signature]</i></p> <p>DATE: _____</p> <p>FILED IN: _____</p> <p>RECORDED IN: _____</p> <p>BY: _____</p> <p>DATE: _____</p> <p>FILED IN: _____</p> <p>RECORDED IN: _____</p>					
<p>PREPARED BY: JIRA, INC.</p> <p>DATE: _____</p> <p>FILED IN: _____</p> <p>RECORDED IN: _____</p>					
<p>SECTION 90060</p> <p>STATE ROAD NO. 5</p> <p>MONROE COUNTY</p>					
<p>FIELD BOOK NO. 13</p> <p>SCALE: 1"=200'</p> <p>SHEET 13 OF 16</p>					

NO.	AREA	ACRES	DATE	REMARKS
1	...	...	...	...
2	...	...	...	...
3	...	...	...	...
4	...	...	...	...
5	...	...	...	...
6	...	...	...	...
7	...	...	...	...
8	...	...	...	...
9	...	...	...	...
10	...	...	...	...

LEGEND

IMPROVED AREA IS VILLAGE OF PALM HARBOR



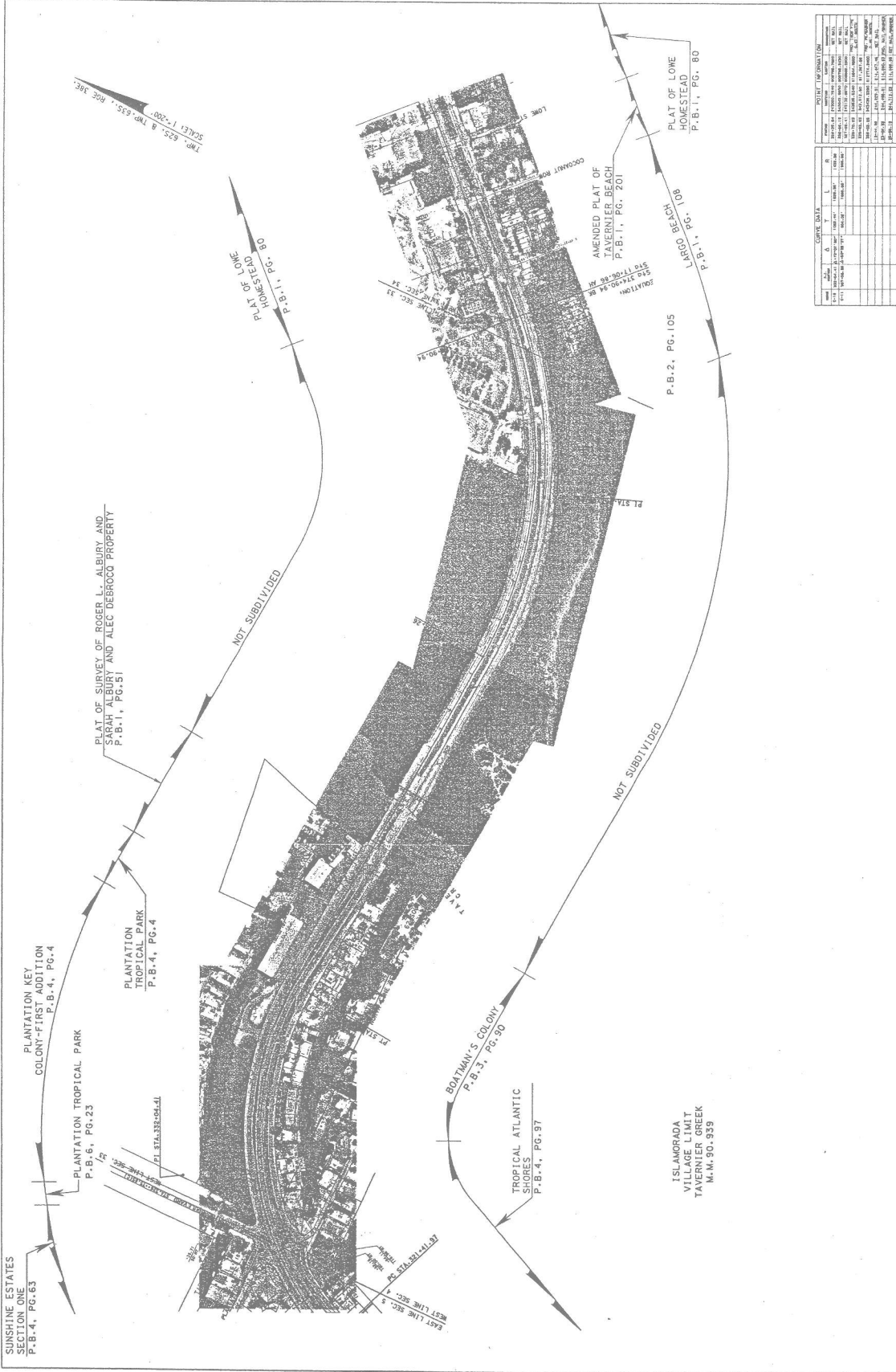

CORNER DATA		POSTED INFORMATION	
STATION	BEARING	DISTANCE	REMARKS
1	N 00° 00' 00" E	100.00	START OF PLAT
2	S 00° 00' 00" E	100.00	END OF PLAT
3	N 00° 00' 00" E	100.00	START OF PLAT
4	S 00° 00' 00" E	100.00	END OF PLAT
5	N 00° 00' 00" E	100.00	START OF PLAT
6	S 00° 00' 00" E	100.00	END OF PLAT
7	N 00° 00' 00" E	100.00	START OF PLAT
8	S 00° 00' 00" E	100.00	END OF PLAT
9	N 00° 00' 00" E	100.00	START OF PLAT
10	S 00° 00' 00" E	100.00	END OF PLAT
11	N 00° 00' 00" E	100.00	START OF PLAT
12	S 00° 00' 00" E	100.00	END OF PLAT
13	N 00° 00' 00" E	100.00	START OF PLAT
14	S 00° 00' 00" E	100.00	END OF PLAT
15	N 00° 00' 00" E	100.00	START OF PLAT
16	S 00° 00' 00" E	100.00	END OF PLAT
17	N 00° 00' 00" E	100.00	START OF PLAT
18	S 00° 00' 00" E	100.00	END OF PLAT
19	N 00° 00' 00" E	100.00	START OF PLAT
20	S 00° 00' 00" E	100.00	END OF PLAT

APPROVED BY	DATE	FILED BOOK NO. 5
<i>[Signature]</i>	11/20/20	
SECTION 90060	STATE ROAD NO. 5	MONROE COUNTY
SR-5 SECTION 90060	SR-4A TRANSFER MAP	SHEET 16 OF 16



This instrument prepared by,  
or under the direction of,  
D. Michael Schloss, Esq. *DM*  
Department of Transportation  
Address: 1000 NW 111<sup>th</sup> Avenue,  
Miami, Florida 33172

Parcel No.: N/A  
Item/Segment No.: 90060  
Managing District: Six

**QUITCLAIM DEED**

THIS INDENTURE, Made this 10<sup>th</sup> of February, 2005 by and between the STATE OF FLORIDA by and through the STATE OF FLORIDA DEPARTMENT OF TRANSPORTATION, Party of the First Part, whose address is 1000 NW 111<sup>th</sup> Avenue, Miami, Florida 33172, to ISLAMORADA, VILLAGE OF ISLANDS, Party of the Second Part, 87000 Overseas Highway, Islamorada, Florida 33036

**WITNESSETH**

WHEREAS, said land hereinafter described was heretofore acquired for state highway purposes; and

WHEREAS, said land is no longer required for such purposes, and the Party of the First Part, by action of the District Secretary, District Six Florida Department of Transportation on September 22, 1971 Pursuant to the provisions of Section 337.25 Florida Statutes, has agreed to quitclaim the land hereinafter described to the Party of the Second Part.

NOW, THEREFORE, THIS INDENTURE WITNESSETH: That the Party of the First Part, for and in consideration of the sum of \$1.00 and other valuable considerations, receipt and sufficiency being hereby acknowledged, does hereby remise, release and quitclaim unto the Party of the Second Part, and assigns, forever, all the right, title and interest in all that certain land situate in Monroe County, Florida, viz:

See Exhibit A attached hereto and made a part hereof

TO HAVE AND TO HOLD, the said premises and the appurtenances thereof unto the Party of the Second Part.

IN WITNESS WHEREOF, the State of Florida Department of Transportation has caused these presents to be signed in the name of the State of Florida and the State of Florida Department of Transportation by its District Secretary, District and its seal to be hereunto affixed, attested by its Executive Secretary, on the date first above written.

ATTEST: *Margaret A. Higgins*  
(type/print name) Margaret A. Higgins  
Executive Secretary

STATE OF FLORIDA  
DEPARTMENT OF TRANSPORTATION  
By: *John Martinez*  
(type/print name) John Martinez  
District Six Secretary

(Affix Department Seal)

STATE OF FLORIDA

COUNTY OF MONROE

The foregoing instrument was acknowledged before me this 21st February 2005, by John Martinez, District Secretary for District Six, who is personally known to me or who has produced N/A as identification.

*Karen Weel*  
(type/print name) KAREN WHEEL  
Notary Public in and for the County and State last aforesaid.  
My Commission Expires: 8/12/08

(Affix Notary Seal)

